

Flexible Rubber Joint Single Sphere Electroplated Carbon Steel Flange Connection (XTQ1RF), PN10/16



XTQ1RF



- Connection Ends: Flange Drilling to BS EN 1092-1
- Working Pressure: PN10/16
- Temperature Range: 0°C- 80°C
- Vacuum Capacity: 700MM/HG

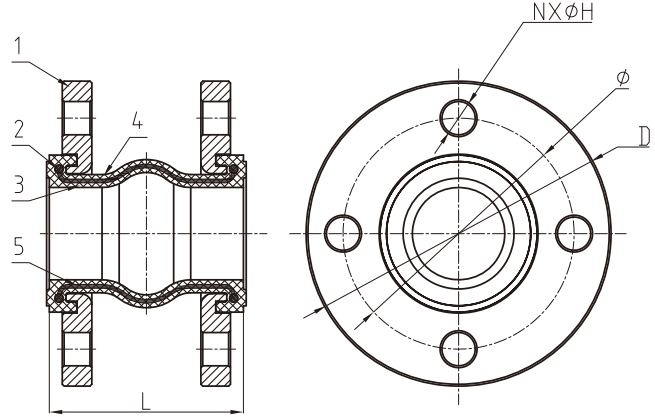

MATERIAL SPECIFICATION

Part No.	Part	Standard Specification
1	Flange	Galvanized Carbon Steel
2	Reinforcing Ring	Carbon Steel
3	Rubber (Inner)	EPDM
4	Rubber (Outer)	EPDM
5	Reinforcing Fabric	Nylon Fabric

Note: For special material request other than standard specification, please indicate clearly on the inquiry or order list.

DN	Neutral Length(mm)					Axial(mm)		Transverse Movement(mm)	Angular Deflection Deg.
	Inch	mm	L	D	Ø	N-ØH	Elongation		
1 1/4"	32	95	140	100	4X18	6	10	10	25
1 1/2"	40	95	150	110	4X18	6	10	10	25
2"	50	105	165	125	4X18	6	10	10	25
2 1/2"	65	115	185	145	8X18	8	15	12	25
3"	80	135	200	160	8X18	8	15	12	25
4"	100	150	220	180	8X18	12	20	16	15
5"	125	165	250	210	8X18	12	20	16	15
6"	150	180	285	240	8X22	12	20	16	15
8"	200	210	340	295	12X22	12	20	16	15
10"	250	230	405	355	12X26	14	30	25	8
12"	300	230	460	410	12X26	14	30	25	8
14"	350	265	520	470	12X26	14	30	25	8
16"	400	265	580	525	16X30	14	30	25	8
18"	450	265	640	585	20X30	14	30	25	8
20"	500	265	715	650	20X33	14	30	25	8
24"	600	265	840	770	20X36	14	30	25	8

